

VRK5872 REPAIR KIT

Instructions for Installation

Disassembly Procedure:

- Step 1: Shut off supply pressure to valve.
- Step 2: Drain off any pressure remaining in the valve.
- Step 3: Unscrew valve from push button assembly via knurled adjusting ring.
- Step 4: Unscrew the adjusting ring assembly from valve body. Usually the supply and outlet tubing may be left connected to valve while repairing valve.
- Step 5: Remove existing diaphragm slip ring, diaphragm assembly, and adjusting spring.
- Step 6: Remove bottom plug from main valve body.
- Step 7: Remove existing bottom plug "O" ring, bottom spring and stem assembly.

Re-assembly Procedure:

- Step 1: Place new bottom plug "O" ring onto bottom plug.
- Step 2: Insert new stem assembly, bottom spring and bottom plug into main valve body as illustrated (making sure the stem assembly is aligned straight). Tighten bottom plug to approximately 20 in.-lbs.
- Step 3: Using new diaphragm assembly, diaphragm slip ring and adjusting spring, re-assemble the top half of the valve as shown in the illustration making sure the center of the stem assembly seats into the center indentation of the diaphragm assembly. Tighten adjusting ring to approximately 40 in.-lbs.
- Step 4: Turn on supply pressure to the valve. Adjust stream height by threading knurled adjusting ring further onto push button assembly for increased flow. Back off 1/8 turn at a time for reduced flow.

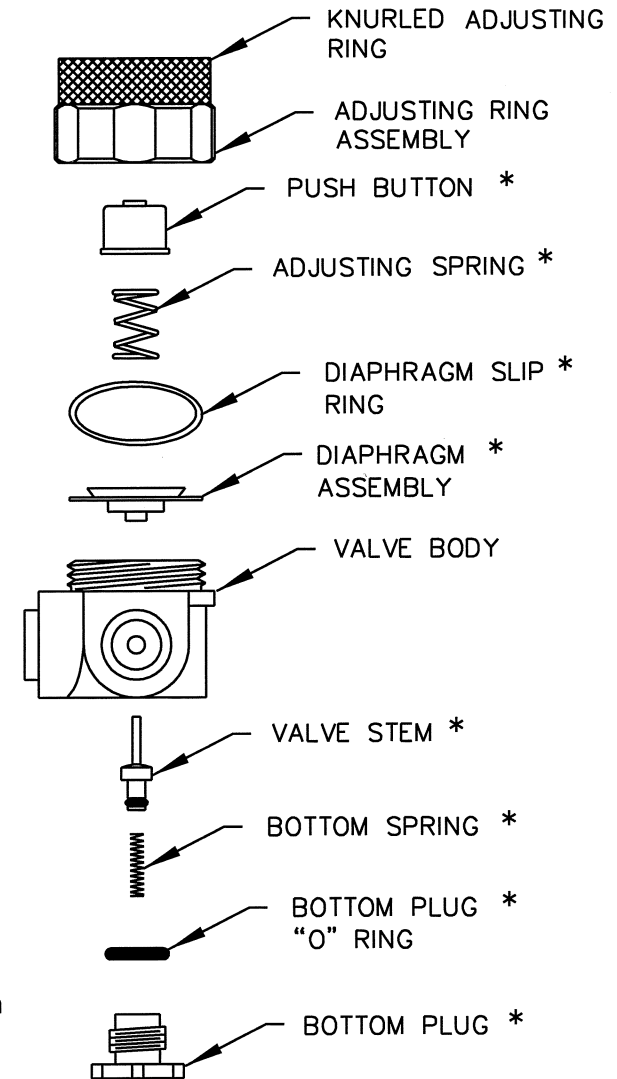

* Indicated parts contained in VRK5872 repair kit.

		INFO FAX : 1-888-FAX-HAWS (1-888-329-4297) 1455 Kleppe Ln, Sparks NV, 89431 Phone: 775-359-4712 Fax: 775-359-7424 Haws Ag Bachweg 3 CH-3401 Burgdorf Switzerland Haws Mfg Pte Ltd 74 Sungei Kadut Loop Singapore 729531 e-mail: Haws@hawsco.com website: www.hawsco.com	
ECR NO. DRAWN: G.E.	REVISED PER ECR: 3910 DATE: 08/27/03	MODEL(S): VRK5872 REPAIR KIT INFO FAX DOC #: 28755872	PART NUMBER: 0002080287 DRAWING NUMBER: 10901C00 REV: 1
APPROVED: <i>[Signature]</i>		SCALE: 1:1	DRAWING TYPE: INSTALLATION/FABRICATION SIZE: A SH: 1 OF 1