



model SP260

Shower Ball Valve

FEATURES & BENEFITS

OPTIONS

To see all options for this model, visit www.hawesco.com



SPECIFICATIONS

Model SP260 is a chrome-plated, stay-open, brass ball shower valve with stainless steel stem for horizontal or vertical installation. Model includes handle. 1" FIPS.

APPLICATIONS



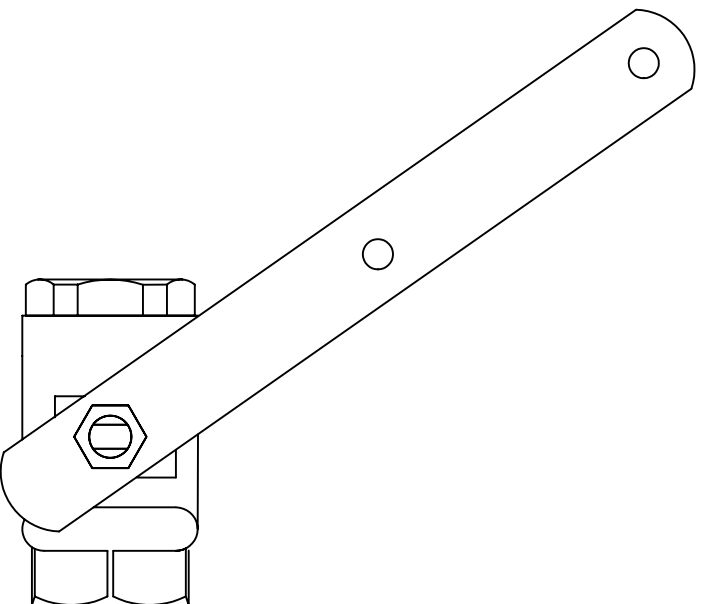

HORIZONTAL CONFIGURATION (STANDARD)

NOTES:

1. WHEN EXISTING SHOWER BALL VALVE NEEDS TO BE REPLACED WITH A NEW MODEL SP260 BALL VALVE, FIRST REMOVE AND CHECK OLD BALL VALVE, THEN:

OPTION 1: IF IT HAS A FULL PORT BUT DOES NOT HAVE A BRASS RESTRICTING WASHER INSTALLED IN FRONT OF THE VALVE BALL, THEN JUST REPLACE IT.

OPTION 2: IF IT HAS A FULL PORT AND A BRASS RESTRICTING WASHER INSTALLED IN FRONT OF THE VALVE BALL, THEN REUSE THE WASHER WHEN INSTALLING THE VALVE.

OPTION 3: IF IT HAS A REDUCED PORT $\varnothing(1/2")$, THEN CALL HAWS TECHNICAL SUPPORT (1-800-766-5612) AND ASK FOR RESTRICTING WASHER.

FAILURE TO DO OPTION 2 OR 3 (IF YOUR SITUATION FITS) COULD RESULT IN THE SHOWER AND THE EYEWASH NOT WORKING SIMULTANEOUSLY.

2. FOR VERTICAL CONFIGURATION: REMOVE HANDLE, FLIP COMPLETELY TO OTHER SIDE AND REATTACH.

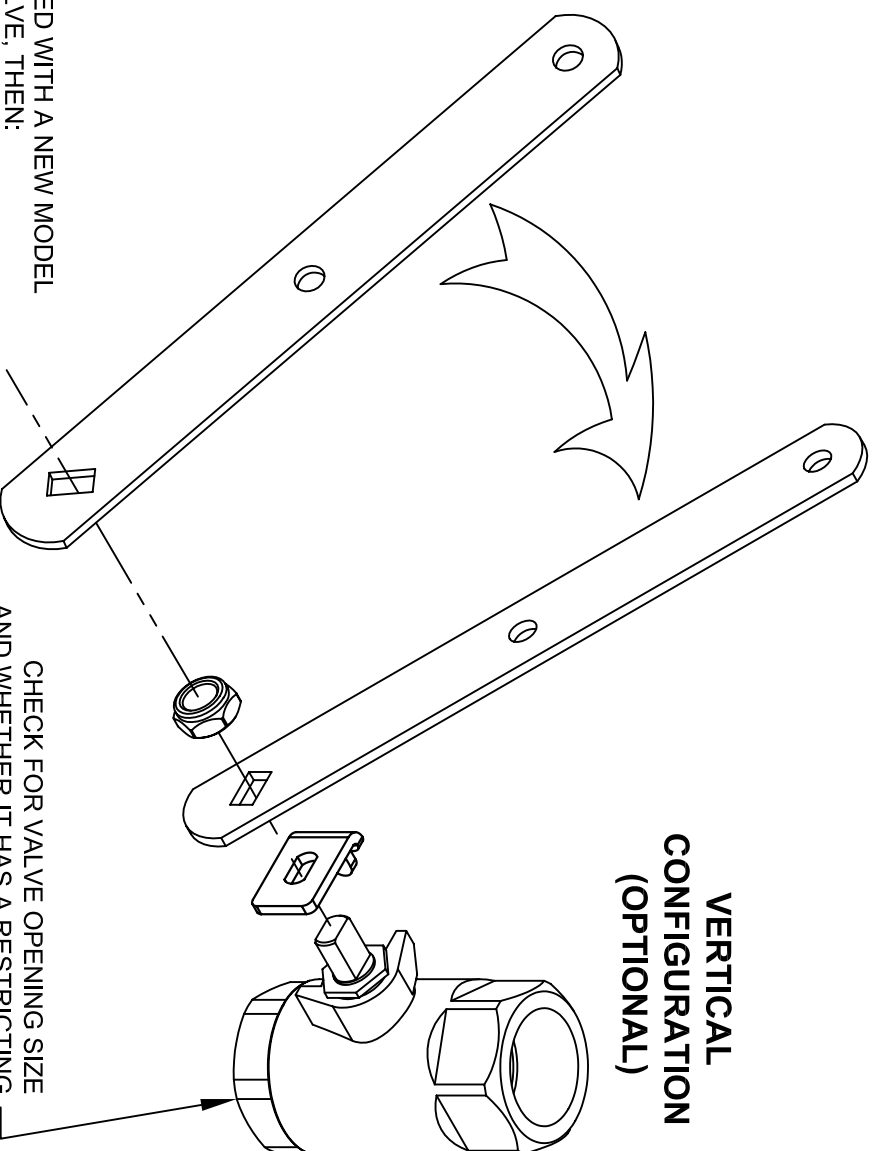

VERTICAL CONFIGURATION (OPTIONAL)



1455 KLEPPE LANE
SPARKS, NEVADA 89431
(775) 359-4712 FAX (756) 359-7424
E-MAIL: HAWS@HAWS.CO.COM
WEBSITE: WWW.HAWS.CO.COM

| | | | | | |
|-------------------------|----------|--------------|-------|---------------|--------------|
| EOM NO. REVISED PER BY: | | MODEL(S) | | PART NUMBER | |
| DRAWING | EQN-4513 | HMA | SP260 | DRAWING NO. | 0002080333 |
| RTM | 07/11/12 | CHKD: | | REV | 4 |
| APPROVED: | DATE: | SCALE: | 1:1 | DRAWING TYPE: | INSTALLATION |
| SIZE: A | | SHEET 1 OF 1 | | | |