



model MK81A

Freeze-protection Bury Valve

FEATURES & BENEFITS

OPTIONS

- ❑ Valve Repair Kit: Model VRKM81A valve repair kit for Model MK81A freeze-proof valve.

To see all options for this model, visit www.hawesco.com



SPECIFICATIONS

Model MK81A is a special freeze-protected valve that drains water from Model 8300FP combination shower/eyewash after closing to prevent freezing. 1-1/4" MIPS inlet. Standard sizes are 60" and 78" (152.4 and 198.1 cm) for bury depths of 24" and 42" (61 and 106.7 cm) respectively. Servicing Instructions: For replacement of damaged parts, order the VRKM81A repair kit which includes packing, stuffing box, stuffing box nut, spring and plunger assembly with four O-rings.

APPLICATIONS



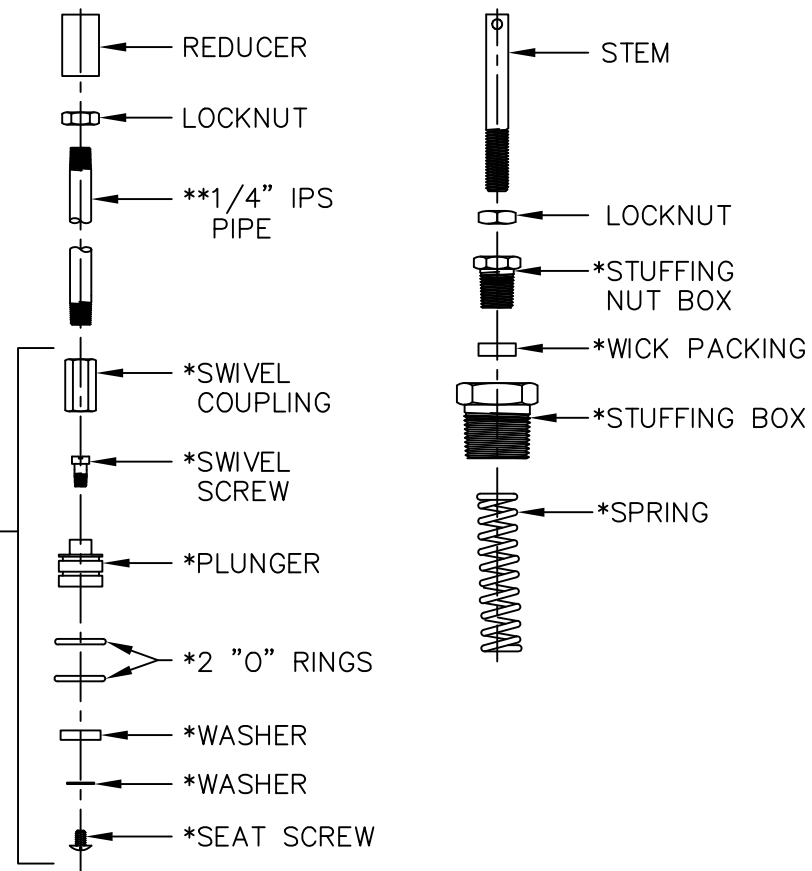
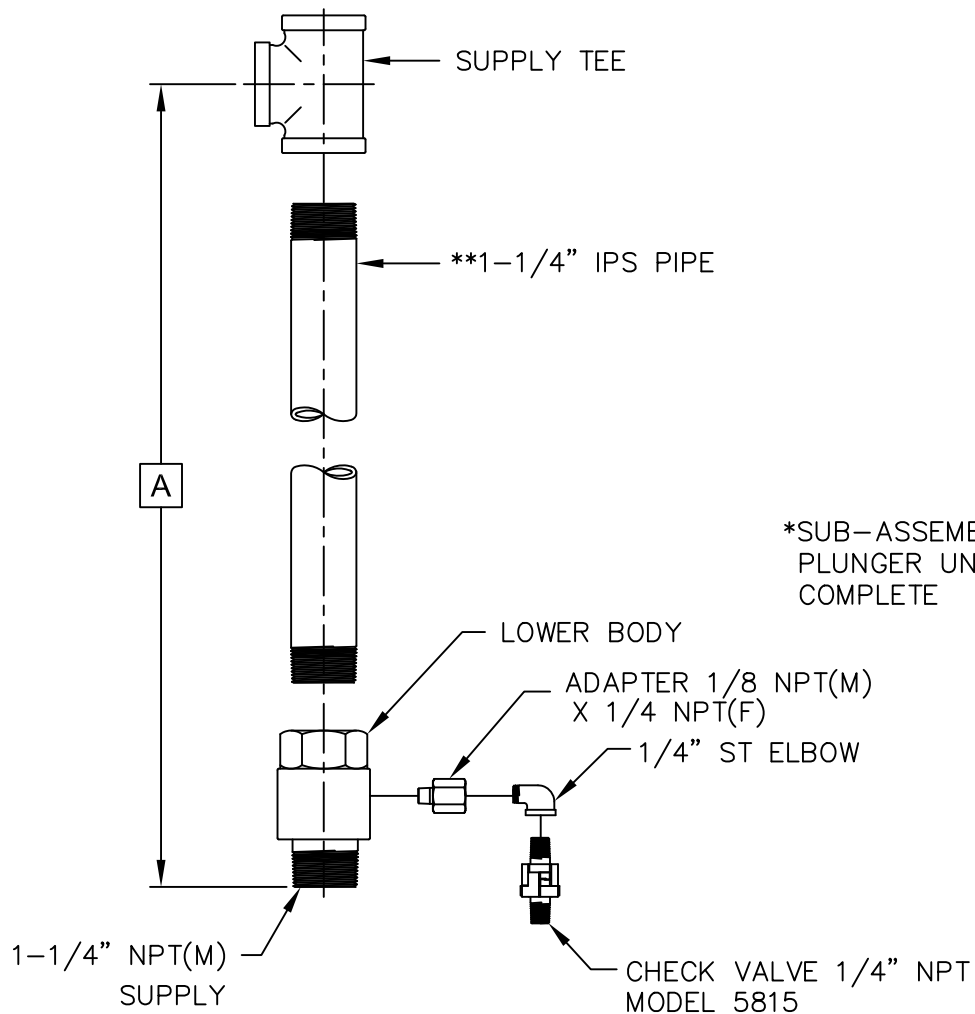

*SUB-ASSEMBLY
PLUNGER UNIT
COMPLETE

REPLACEMENT PARTS FOR ITEMS MARKED WITH AN ASTERISK (*) ARE INCLUDED IN VALVE REPAIR KIT MODEL VRKMK81A AVAILABLE FROM HAWS.

** SPECIFY BURY DEPTH WHEN ORDERING THESE PARTS

A	FOR BURY DEPTH
60"	24"
78"	42"



1455 KLEPPE LANE
SPARKS, NEVADA 89431
(775) 359-4712 FAX (775) 359-7424
E-MAIL: HAWS@HAWS.CO.COM
WEBSITE: WWW.HAWS.CO.COM

ECN NO.	REVISED PER BY:	MODEL(S)	PART NUMBER:
	ECN: 4561 VWC	MK81A FREEZE PROOF VALVE	0002080289.D
DRAWN:	DATE:	CHKD.:	DRAWING NO.:
C.H.	08/90		07866C00
APPROVED:	DATE:	SCALE: 1:5	DRAWING TYPE: INSTALLATION
			SIZE: A SHEET 1 OF 1